

THIRDWAY

ASHBY CAPITAL

**THE FUTURE WORKS
SLOUGH
SL1 1XU**

SKETCH

08

20.04.2020

FS

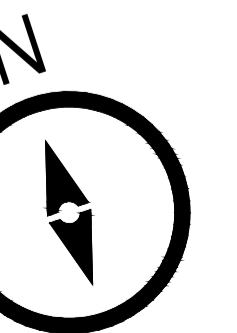

© THIRDWAY INTERIORS

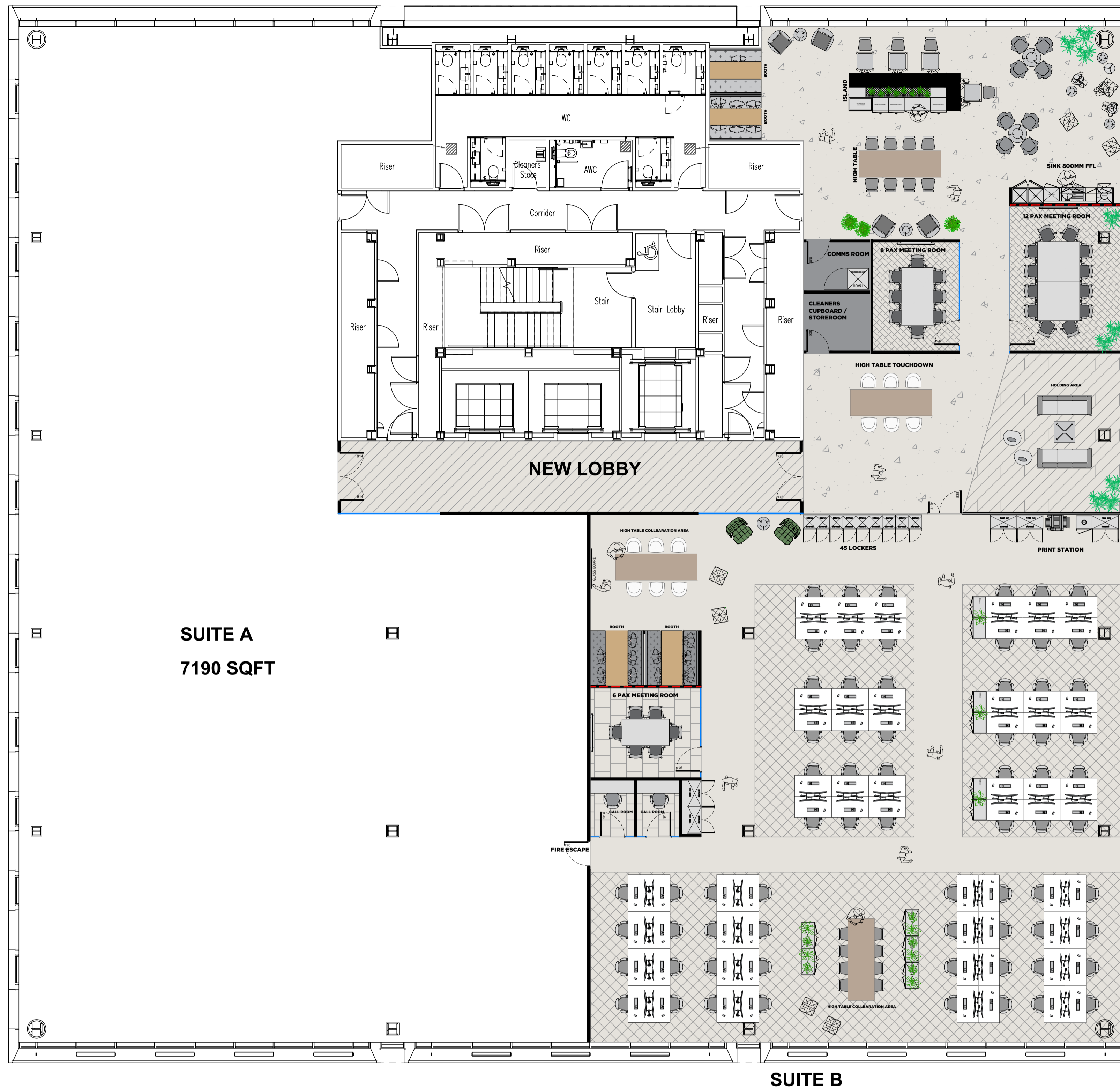

SECOND FLOOR

SCALE | 1:100 @A1 | 1:200 @A3

TOTAL AREA | 1359 M2 | 14629 SQ FT
 DEMISE AREA | 6878 SQ FT
 OCCUPANCY | 1:10 68 | 1:8 85
 CEILING HEIGHT | 2.9m

- 68 | DESKS @1400X800MM
- 01 | 6 PAX MEETING ROOM
- 01 | 8 PAX MEETING ROOM
- 01 | 10-12 PAX MEETING ROOM
- 04 | BOOTHS
- 02 | CALL ROOMS

- 01 | PRINT STATION
- 02 | COLLABORATION AREAS
- 06 | HOT DESKS
- 01 | COMMS ROOMS
- 01 | CLEANERS AND STORE CUPBOARD

- 01 | DDA TEA POINT
- 01 | BREAKFAST ISLANDS
- 01 | BANQUETTE
- 45 | LOCKERS
- XX | STORAGE